

SCHOTTKY BARRIER RECTIFIERS

Features

- 3A Schottky barrier diode
- Schottky barrier rectifier
- Guarding protection
- Low forward voltage
- Reverse energy tested
- High current capability
- Extremely low thermal resistance

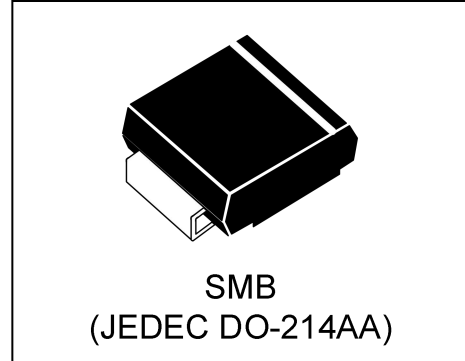

Mechanical Data

- Case: SMB(JEDEC DO-214AA),molded plastic body
- Mounting position: any
- Polarity: Color band denotes cathode end

Absolute Maximum Ratings and Electronics characteristics

Ratings@25°C ambient temperature unless otherwise specified

Parameter	Symbol	WSR2003B	WSR4003B	WSR6003B	WSR8003B	WSR10003B	WSR12003B	WSR15003B	WSR20003B	UNITS
Maximum repetitive peak reverse voltage	V_{RRM}	20	40	60	80	100	120	150	200	V
Maximum RMS voltage	V_{RMS}	14	28	42	56	70	84	105	140	V
Maximum DC blocking voltage	V_{DC}	20	40	60	80	100	120	150	200	V
Maximum average forward rectified current	$I_{F(AV)}$	3.0								A
Peak forward surge current 8.3ms single half-sine-wave	I_{FSM}	70								A
Maximum instantaneous forward voltage at $I_F=3.0A$	V_F	0.55		0.7	0.85			0.95		V
Maximum DC reverse current ($T_a=25^\circ C$) At rated DC blocking voltage ($T_a=100^\circ C$)	I_R	0.5 10			0.3 5					mA
Typical Junction Capacitance(measured at 1MHz and applied reverse voltage of 4V D.C.)	C_j	450				400				pF
Typical thermal resistance(junction to ambient)	$R_{\theta JA}$	55								°C/W
Operating temperature range	T_J	-55 ~ +125								°C
Storage temperature range	T_{STG}	-55 ~ +150								°C

Typical characteristics (Ta=25°C, unless otherwise noted)

Fig. 1 - PEAK FORWARD SURGE CURRENT

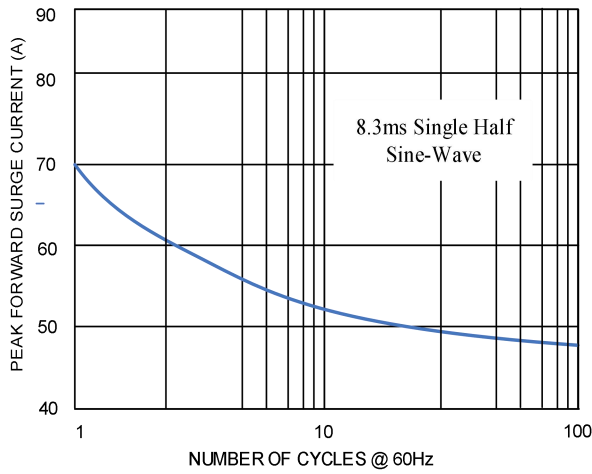

Fig. 2 - FORWARD CURRENT DERATING CURVE

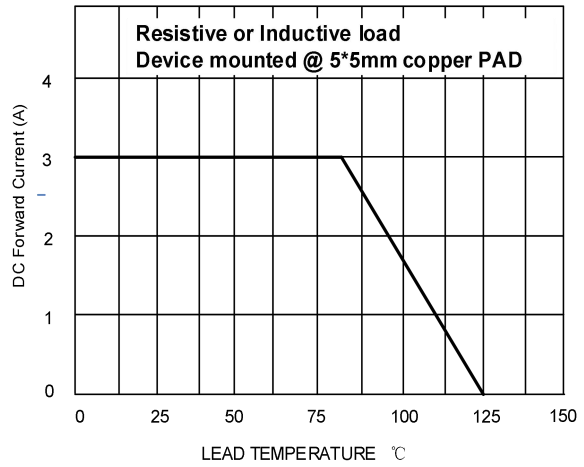

Fig.3 Typical Forward Characteristic

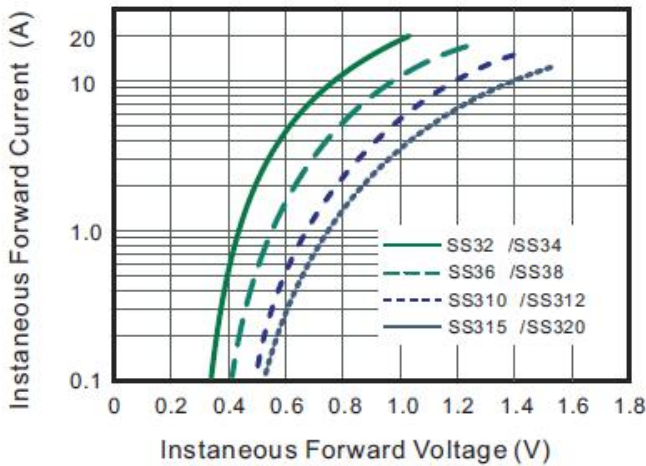
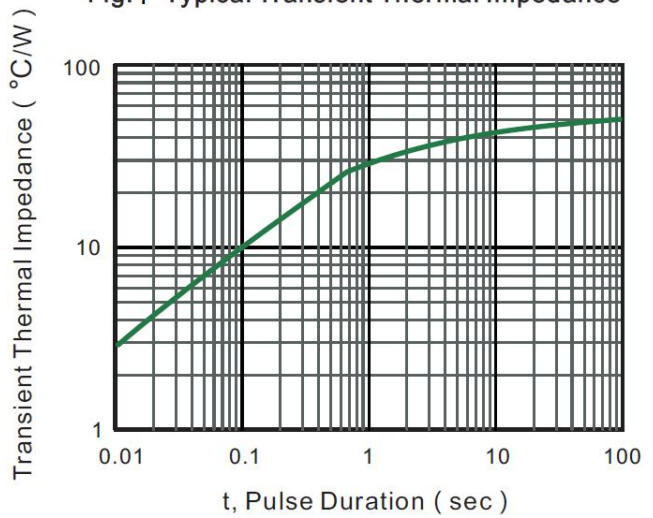
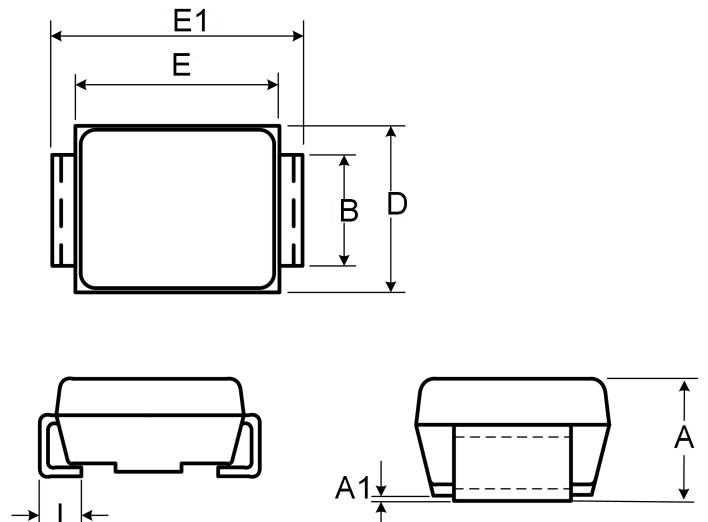

Fig.4- Typical Transient Thermal Impedance



Outline Drawing

Ref. (mm)	Millimeters	
	Min.	Max.
A	1.990	2.610
A1	-	0.300
B	1.850	2.200
E	4.060	4.750
E1	5.080	5.590
D	3.300	3.940
L	0.760	1.520



Recommended Solder Pad Layout

DIM(mm)	MILLIMETERS
A	2.74
B	2.26
C	2.16

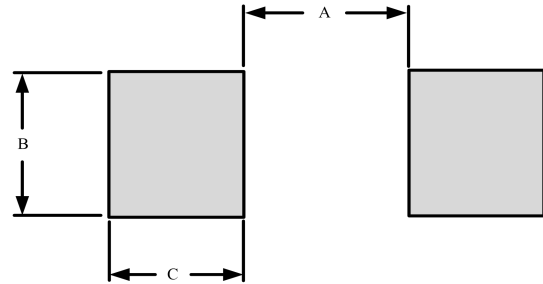

Marking Code

Part Number	WSR2003B	WSR4003B	WSR6003B	WSR8003B
Marking Code	SS32	SS34	SS36	SS38
Part Number	WSR10003B	WSR12003B	WSR15003B	WSR20003B
Marking Code	SS310	SS312	SS315	SS320

Package Information

Tape & Reel: 3000 pcs.

Contact Information

No.1001, Shiwan(7) Road, Pudong District, Shanghai, P.R.China.201207

Tel: 021-68969993 Fax: 86-21-50757680 Email: market@way-on.com

WAYON website: <http://www.way-on.com>

For additional information, please contact your local Sales Representative.

WAYON® is registered trademarks of Wayon Corporation.

*Specifications are subject to change without notice.
The device characteristics and parameters in this data sheet can and do vary in different applications and actual device performance may vary over time.
Users should verify actual device performance in their specific applications.*